

UHP Fittings (Clean Fittings)

The best partner for value creation
We support the innovations of customer



06



Catalogue No. S-LOK Mar.2024

Micro Weld Fittings

Micro Elbow
C-ML 202



Micro 45° Elbow
C-MLB 202



Micro Reducing Elbow
C-MRL 203



Micro Tee
C-MT 203



Micro Reducing Tee
C-MRT 204



Micro Cross
C-MX 204



Micro Tribow
C-MTB 205



Micro Reducing Union
C-MRU 205



Tube Butt Weld Fittings

Long Elbow
C-LL 207



Long Reducing Elbow
C-LRL 207



Long Tee
C-LT 208



Long Reducing Tee
C-LRT 209



Long Cross
C-LX 210



Long Reducing Union
C-LRU 211



Metal Face Seal Fittings

Micro Gland for Female Nut
C-MGF 213



Micro Gland for male Nut
C-MGM 213



Long Gland for Female Nut
C-LGF 214



Long Gland for Male Nut
C-LGM 214



ATW Long Gland for Female Nut
C-ALGF 215



ATW Long Gland for Male Nut
C-ALGM 215



Soket Weld Gland
C-GSW 216



Male Weld Gland
C-GMW



216

Tube Adapter Gland
C-GA



217

Blind Gland
C-GBL



217

Union
C-U



218

Bulkhead Union
C-BU



218

Male Connector
C-MC-N



219

Tube Butt Weld Connector
C-TC



219

Tube Butt Weld Bulkhead Connector
C-TCB



220

Coupling
C-CG



220

Union Elbow
C-L



221

Male Elbow
C-MLC



221

Union Tee
C-T



222

Union Cross
C-X



222

S-LOK Tube Fitting Connector
C-US



223

S-LOK Tube Fitting Connector
Bulkhead Connector
C-USB



223

Male Bulkhead Connector
Male Connector (Straight Thread)
C-MBC/C-MC-U



224

Female Connector
C-FC



225

Gasket Retainer Assembly
C-GTR



225

Gasket
C-GT



226

Female Nut
C-NF



226

Male Nut / Cap
C-NM/C-CP



227

Plug
C-PG



228

High Flow Gland
C-HG



228

Welded Assemblies



229

Technical Data

Pressure Ratings

- Pressure ratings are based on allowable stress value of 20,000psi as specified in ASME B31.3 for 316 stainless steel.
- Pressure ratings of Metal Face Seal Fittings determined at room temperature with gasket materials shown.
- For pressure ratings of ASME B31.1, multiply working pressure by 0.94.
- Allowable working pressure at temperatures greater than 100°C (37°C) may be determined by multiple factors in the table below.

Material	SS316	SS316L
Temperature, °F (°C)	Factor	
-20 (28) to 100 (37)	1.00	1.00
200 (93)	1.00	0.83
400 (204)	0.96	0.77
600 (315)	0.85	0.67
800 (426)	0.79	0.62
1000 (537)	0.76	0.56

Cleaning and Packaging

- Passivation in a nitric environment
- Ultra-sonic cleaning with minimum 18M of D.I water after passivation.
- All fittings are double packaged in the clean room.
- Sealing parts are protected with a plastic cap.

Temperature Ratings

Components	Material	Temperature °F (°C)
Fittings	316 Stainless Steel & 316L Stainless Steel	1000 (537)
	316L Stainless Steel Single Melt	
	316L Stainless Steel Double Melt	
Gaskets	316L Stainless Steel	1000 (537)
	Nickel	600 (315)

Materials

Material	Designator	Specifications
316 Stainless Steel	S6	Bar Stock : ASTM A479 ASTM A276
316L Stainless Steel	S6L	Forging : ASTM A182
316L Stainless Steel Single Melt (VOD)	S6LS	Bar Stock : ASTM A479 ASTM A276
316L Stainless Steel Double Melt (VAR)	S6LV	Forging : ASTM A182 SEMI SPEC. F20-0706E
316L Stainless Steel Double Melt (VIM/VAR)	S6LVV	JIS SPEC. Chemical Composition

Product Grade

Level	Inner Surface Roughness	
	Ra	Ry
EP	≤ 5 μ inch	≤ 0.7 μm
BA	≤ 10 μ inch	≤ 3.0 μm
AP	≤ 100 μ inch	≤ 25 μm

Chemical Composition

Element	Composition, Wt%									
	C	Si	Mn	P	S	Ni	Cr	Mo	Cu	Al
SS316L Single Melt	≤ 0.03	≤ 1.0	≤ 0.8	≤ 0.045	≤ 0.005	12.0~15.0	16.0~18.0	2.0~3.0	≤ 0.3	-
SS316L Double Melt	≤ 0.025	≤ 0.3	≤ 0.4	≤ 0.045	≤ 0.005	14.5~15.0	16.0~17.0	2.2~2.5	≤ 0.03	≤ 0.01
SS316L VIM/VAR	≤ 0.01	≤ 0.2	≤ 0.05	≤ 0.02	≤ 0.003	14.5~15.0	16.5~17.0	2.2~2.5	≤ 0.2	≤ 0.01

Micro Weld Fittings

Features

- Compact design for mainly gas line
- Suitable for miniature tubing system
- Allows close component spacing
- Provides flow capacity equal to larger weld fittings



Laser marking
Manufacturer / Material / HCN

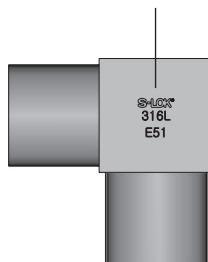

Sharp and burr-free
tube weld end.

Standard surface finish is
BA: Ra 0.25 μm
EP: Ra 0.13 μm

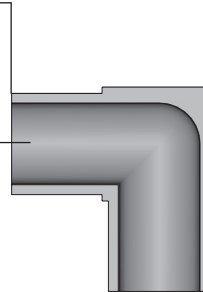

Radius junction for
smooth transition
and elimination
of entrapment zones

Ordering Information



Clean Fitting	Product Type	Connection Size	Product Grade	Body Material
- C : S-LOK UHP Product	Refer to the basic ordering number in the dimension table.	- 4 : 1/4" - 6 : 3/8" - 8 : 1/2" - 12 : 3/4"	- BA : BA - EP : EP	- S6LS : SS316L Single Melt - S6LV : SS316L Double Melt

Micro Elbow

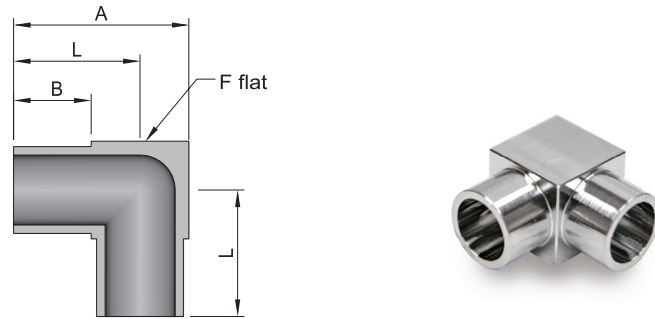

Basic Ordering Number	Tube O.D.	Wall THK.	Dimensions, mm (inch)				Pressure Rating bar (psig)
			A	B	L	F	
C-ML-2	1/8"	0.028"	14.4 (0.56)	6.4 (0.25)	10.4 (0.41)	7.94 (5/16)	585 (8500)
C-ML-4	1/4"	1mm	14.4 (0.56)	6.4 (0.25)	10.4 (0.41)	7.94 (5/16)	351 (5100)
C-ML-4T35		0.035"					
C-ML-6	3/8"	1mm	17.4 (0.69)	6.4 (0.25)	11.9 (0.47)	11.11 (7/16)	227 (3300)
C-ML-6T35		0.035"					
C-ML-8	1/2"	0.049"	20.6 (0.81)	6.4 (0.25)	13.5 (0.53)	14.28 (9/16)	254 (3700)
C-ML-12	3/4"	0.065"	27.0 (1.06)	6.4 (0.25)	16.7 (0.66)	20.64 (13/16)	165 (2400)

Micro 45° Elbow

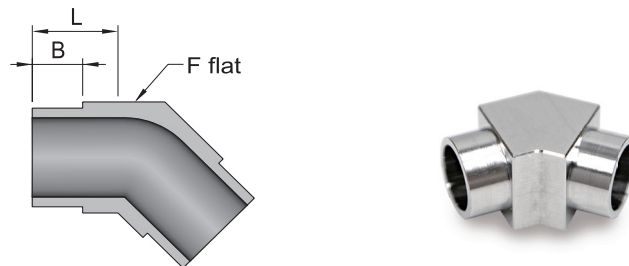

Basic Ordering Number	Tube O.D.	Wall THK.	Dimensions, mm (inch)			Pressure Rating bar (psig)
			B	L	F	
C-MLB-4	1/4"	1mm	6.35 (0.25)	10.10 (0.40)	7.94 (5/16)	351 (5100)
C-MLB-4T35	1/4"	0.035"	6.35 (0.25)	10.10 (0.40)	7.94 (5/16)	351 (5100)
C-MLB-6	3/8"	1mm	6.35 (0.25)	11.91 (0.47)	11.11 (7/16)	227 (3300)
C-MLB-6T35	3/8"	0.035"	6.35 (0.25)	11.91 (0.47)	11.11 (7/16)	227 (3300)
C-MLB-8	1/2"	0.049"	6.35 (0.25)	13.50 (0.53)	14.29 (9/16)	254 (3700)

Micro Reducing Elbow

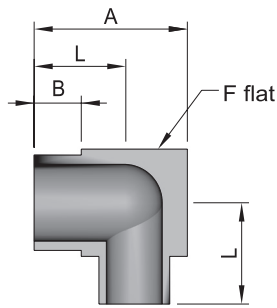

Basic Ordering Number	Tube O.D 1 x Wall THK.	Tube O.D 2 x Wall THK.	Dimensions, mm (inch)				Pressure Rating bar (psig)
			A	B	L	F	
C-MRL-4-2	1/4" x 1mm	1/8" x 0.028"	14.4 (0.56)	6.4 (0.25)	10.4 (0.41)	7.94 (5/16)	351 (5100)
C-MRL-6-4	3/8" x 1mm	1/4" x 1mm	17.4 (0.69)	6.4 (0.25)	11.9 (0.47)	11.11 (7/16)	227 (3300)
C-MRL-6-4-035	3/8" x 0.035"	1/4" x 0.035"					
C-MRL-8-4	1/2" x 0.049"	1/4" x 1mm	20.6 (0.81)	6.4 (0.25)	13.5 (0.53)	14.28 (9/16)	254 (3700)
C-MRL-8-4T35		1/4" x 0.035"					
C-MRL-8-6	1/2" x 0.049"	3/8" x 1mm	20.6 (0.81)	6.4 (0.25)	13.5 (0.53)	14.28 (9/16)	227 (3300)
C-MRL-8-6T35		3/8" x 0.035"					
C-MRL-12-4	3/4" x 0.065"	1/4" x 1mm	27.0 (1.06)	6.4 (0.25)	16.7 (0.66)	20.64 (13/16)	165 (2400)
C-MRL-12-6		3/8" x 1mm					
C-MRL-12-8		1/2" x 0.049"					

Micro Tee

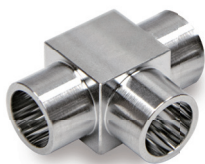
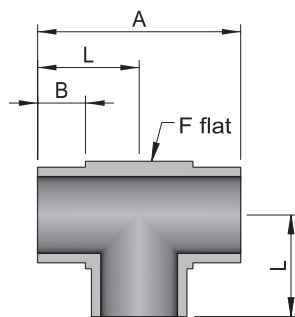

Basic Ordering Number	Tube O.D	Wall THK.	Dimensions, mm (inch)				Pressure Rating bar (psig)
			A	B	L	F	
C-MT-2	1/8"	0.028"	20.8 (0.82)	6.4 (0.25)	10.4 (0.41)	7.94 (5/16)	585 (8500)
C-MT-4	1/4"	1mm	20.8 (0.82)	6.4 (0.25)	10.4 (0.41)	7.94 (5/16)	351 (5100)
C-MT-4T35		0.035"					
C-MT-6	3/8"	1mm	23.8 (0.94)	6.4 (0.25)	11.9 (0.47)	11.11 (7/16)	227 (3300)
C-MT-6T35		0.035"					
C-MT-8	1/2"	0.049"	27.0 (1.06)	6.4 (0.25)	13.5 (0.53)	14.28 (9/16)	254 (3700)
C-MT-12	3/4"	0.065"	33.4 (1.31)	6.4 (0.25)	16.7 (0.66)	20.64 (13/16)	165 (2400)

Micro Reducing Tee

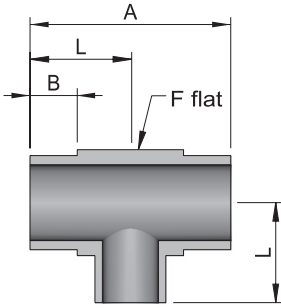

Basic Ordering Number	Tube O.D 1 x Wall THK.	Tube O.D 2 x Wall THK.	Dimensions, mm (inch)				Pressure Rating bar (psig)
			A	B	L	F	
C-MRT-4-2	1/4" x 1mm	1/8" x 0.028"	20.8 (0.82)	6.4 (0.25)	10.4 (0.41)	7.94 (5/16)	351 (5100)
C-MRT-6-4	3/8" x 1mm	1/4" x 1mm	23.8 (0.94)	6.4 (0.25)	11.9 (0.47)	11.11 (7/16)	227 (3300)
C-MRT-6-4-035	3/8" x 0.035"	1/4" x 0.035"					
C-MRT-8-4	1/2" x 0.049"	1/4" x 1mm	27.0 (1.06)	6.4 (0.25)	13.5 (0.53)	14.28 (9/16)	254 (3700)
C-MRT-8-4T35		1/4" x 0.035"					
C-MRT-8-6	1/2" x 0.049"	3/8" x 1mm	27.0 (1.06)	6.4 (0.25)	13.5 (0.53)	14.28 (9/16)	227 (3300)
C-MRT-8-6T35		3/8" x 0.035"					
C-MRT-12-4	3/4" x 0.065"	1/4" x 1mm	33.4 (1.31)	6.4 (0.25)	16.7 (0.66)	20.64 (13/16)	165 (2400)
C-MRT-12-6		3/8" x 1mm					
C-MRT-12-8		1/2" x 0.049"					

Micro Cross

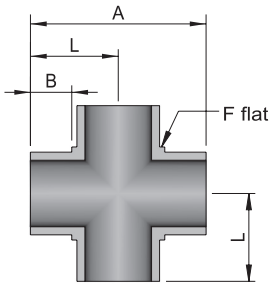

Basic Ordering Number	Tube O.D	Wall THK.	Dimensions, mm (inch)				Pressure Rating bar (psig)
			A	B	L	F	
C-MX-4	1/4"	1mm	20.8 (0.82)	6.4 (0.25)	10.4 (0.41)	7.94 (5/16)	351 (5100)
C-MX-4T35		0.035"					
C-MX-6	3/8"	1mm	23.8 (0.94)	6.4 (0.25)	11.9 (0.47)	11.11 (7/16)	227 (3300)
C-MX-6T35		0.035"					
C-MX-8	1/2"	0.049"	27.0 (1.06)	6.4 (0.25)	13.5 (0.53)	14.28 (9/16)	254 (3700)

Micro Tribow

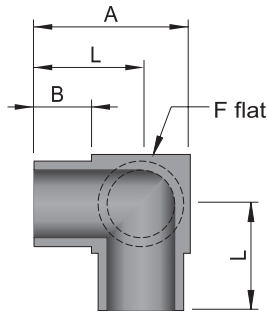

Basic Ordering Number	Tube O.D	Wall THK.	Dimensions, mm (inch)				Pressure Rating bar (psig)
			A	B	L	F	
C-MTB-4	1/4"	1mm	14.4 (0.56)	6.4 (0.25)	10.4 (0.41)	7.94 (5/16)	351 (5100)
C-MTB-4T35		0.035"					
C-MTB-6	3/8"	1mm	17.4 (0.69)	6.4 (0.25)	11.9 (0.47)	11.11 (7/16)	227 (3300)
C-MTB-6T35		0.035"					
C-MTB-8	1/2"	0.049"	20.6 (0.81)	6.4 (0.25)	13.5 (0.53)	14.28 (9/16)	254 (3700)



Micro Reducing Union

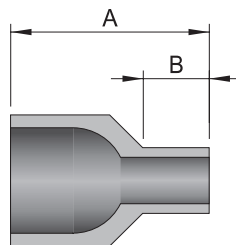

Basic Ordering Number	Tube O.D 1 x Wall THK.	Tube O.D 2 x Wall THK.	Dimensions, mm (inch)		Pressure Rating bar (psig)
			A	B	
C-MRU-6-4	3/8" x 1mm	1/4" x 1mm	19.1(0.75)	6.4 (0.25)	227 (3300)
C-MRU-6-4-035	3/8" x 0.035"	1/4" x 0.035"			
C-MRU-8-4	1/2" x 0.049"	1/4" x 1mm	19.1 (0.75)	6.4 (0.25)	254 (3700)
C-MRU-8-4T35		1/4" x 0.035"			
C-MRU-8-6	1/2" x 0.049"	3/8" x 1mm	19.1 (0.75)	6.4 (0.25)	227 (3300)
C-MRU-8-6T35		3/8" x 0.035"			
C-MRU-12-4	3/4" x 0.065"	1/4" x 1mm	19.1 (0.75)	6.4 (0.25)	165 (2400)
C-MRU-12-6		3/8" x 1mm			
C-MRU-12-8		1/2" x 0.049"			



Tube Butt Weld Fittings

Features

- Square, sharp, burr-free tube weld ends
- Laser marking – Manufacturer, Material, HCN
- Machined for optimal tube butt welding suitable automatic TIG welder.



Tube Butt Weld Fitting

Sharp and burr-free tube weld end.

Standard surface finish is
BA: Ra 0.25 μm
EP: RA 0.13 μm

Precisely finished diameter matches tube diameter.

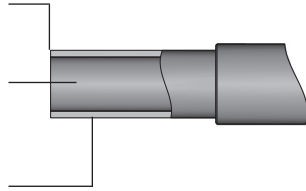

Automatic Tube Butt Weld Fitting

Sharp and burr-free tube weld end.

Standard surface finish is
BA: Ra 0.25 μm
EP: RA 0.13 μm

Precisely finished diameter matches tube diameter.

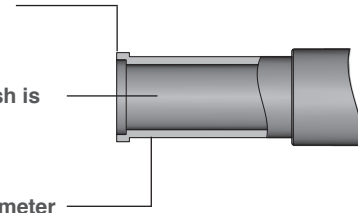

Ordering Information



Clean Fitting	Product Type	Connection Size	Product Grade	Body Material
- C : S-LOK UHP Product	Refer to the basic ordering number in the dimension table.	- 4 : 1/4" - 6 : 3/8" - 8 : 1/2" - 12 : 3/4" - 16 : 1"	- BA : BA - EP : EP	- S6LS : SS316L Single Melt - S6LV : SS316L Double Melt

Long Elbow

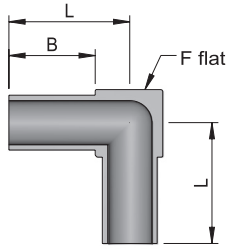

Basic Ordering Number	Tube O.D	Wall THK.	Dimensions, mm (inch)			Pressure Rating bar (psig)
			B	L	F	
C-LL-4	1/4"	1mm	19.1 (0.75)	25.0 (0.98)	11.1 (0.44)	351 (5100)
C-LL-4T35		0.035"				
C-LL-4-L10		1mm				
C-LL-6	3/8"	1mm	19.1 (0.75)	25.0 (0.98)	11.1 (0.44)	227 (3300)
C-LL-6T35		0.035"				
C-LL-6-L10		1mm				
C-LL-8	1/2"	0.049"	19.1 (0.75)	29.0 (1.14)	17.0 (0.67)	254 (3700)
C-LL-8-L10			10.0 (0.39)	19.9 (0.78)		
C-LL-12	3/4"	0.065"	22.5 (0.89)	33.5 (1.32)	25.0 (0.98)	165 (2400)
C-LL-12T49		0.049"				
C-LL-12-L10		0.065"				
C-LL-16	1"	0.065"	23.3 (0.92)	38.3 (1.51)	30.0 (1.18)	165 (2400)

Long Reducing Elbow

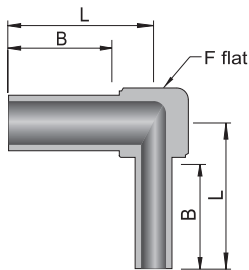

Basic Ordering Number	Tube O.D 1 x Wall THK.	Tube O.D 2 x Wall THK.	Dimensions, mm (inch)			Pressure Rating bar (psig)
			B	L	F	
C-LRL-6-4	3/8" x 1mm	1/4" x 1mm	19.1 (0.75)	25.0 (0.98)	11.1 (0.44)	227 (3300)
C-LRL-6-4-035	3/8" x 0.035"	1/4" x 0.035"				
C-LRL-6-4-L10	3/8" x 1mm	1/4" x 1mm				
C-LRL-8-4	1/2" x 0.049"	1/4" x 1mm	19.1 (0.75)	29.0 (1.14)	17.0 (0.67)	254 (3700)
C-LRL-8-4T35		1/4" x 0.035"				
C-LRL-8-4-L10		1/4" x 1mm				
C-LRL-8-6	1/2" x 0.049"	3/8" x 1mm	19.1 (0.75)	29.0 (1.14)	17.0 (0.67)	227 (3300)
C-LRL-8-6T35		3/8" x 0.035"				
C-LRL-8-6-L10		3/8" x 1mm				
C-LRL-12-4	3/4" x 0.065"	1/4" x 1mm	22.5 (0.89)	33.5 (1.32)	25.0 (0.98)	165 (2400)
C-LRL-12-4T35		1/4" x 0.035"				
C-LRL-12-4-L10		1/4" x 1mm				
C-LRL-16-8	1" x 0.065"	1/2" x 0.049"	23.3 (0.92)	38.3 (1.51)	30.0 (1.18)	165 (2400)

Long Tee

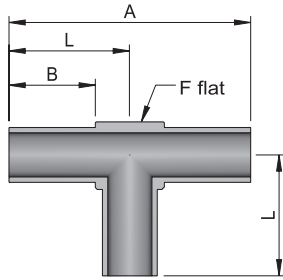

Basic Ordering Number	Tube O.D.	Wall THK.	Dimensions, mm (inch)				Pressure Rating bar (psig)
			A	B	L	F	
C-LT-4	1/4"	1mm	50.0 (1.97)	19.1 (0.75)	25.0 (0.98)	11.1 (0.44)	351 (5100)
C-LT-4T35		0.035"					
C-LT-4-L10		1mm	31.8 (1.25)	10.0 (0.39)	15.9 (0.63)		
C-LT-6	3/8"	1mm	50.0 (1.97)	19.1 (0.75)	25.0 (0.98)	11.1 (0.44)	227 (3300)
C-LT-6T35		0.035"					
C-LT-6-L10		1mm	31.8 (1.25)	10.0 (0.39)	15.9 (0.63)		
C-LT-8	1/2"	0.049"	58.0 (2.28)	19.1 (0.75)	29.0 (1.14)	17.0 (0.67)	254 (3700)
C-LT-8-L10			39.8 (1.57)	10.0 (0.39)	19.9 (0.78)		
C-LT-12	3/4"	0.065"	67.0 (2.64)	22.5 (0.89)	33.5 (1.32)	25.0 (0.98)	165 (2400)
C-LT-12T49		0.049"					
C-LT-12-L10		0.065"	44.8 (1.76)	10.0 (0.39)	22.4 (0.88)		
C-LT-16	1"	0.065"	76.6 (3.02)	23.3 (0.92)	38.3 (1.51)	30.0 (1.18)	165 (2400)

Long Reducing Tee

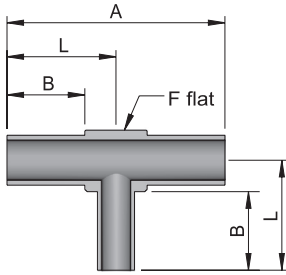

Basic Ordering Number	Tube O.D 1 x Wall THK.	Tube O.D 2 x Wall THK.	Dimensions, mm (inch)				Pressure Rating bar (psig)
			A	B	L	F	
C-LRT-6-4	3/8" x 1mm	1/4" x 1mm	50.0 (1.97)	19.1 (0.75)	25.0 (0.98)	11.1 (0.44)	227 (3300)
C-LRT-6-4-035	3/8" x 0.035"	1/4" x 0.035"					
C-LRT-6-4-L10	3/8" x 1mm	1/4" x 1mm	31.8 (1.25)	10.0 (0.39)	15.9 (0.63)		
C-LRT-8-4	1/2" x 0.049"	1/4" x 1mm	58.0 (2.28)	19.1 (0.75)	29.0 (1.14)	17.0 (0.67)	254 (3700)
C-LRT-8-4T35		1/4" x 0.035"					
C-LRT-8-4-L10		1/4" x 1mm	39.8 (1.57)	10.0 (0.39)	19.9 (0.78)		
C-LRT-8-6	1/2" x 0.049"	3/8" x 1mm	58.0 (2.28)	19.1 (0.75)	29.0 (1.14)	17.0 (0.67)	227 (3300)
C-LRT-8-6T35		3/8" x 0.035"					
C-LRT-8-6-L10		3/8" x 1mm	39.8 (1.57)	10.0 (0.39)	19.9 (0.78)		
C-LRT-12-4	3/4" x 0.065"	1/4" x 1mm	67 (2.64)	22.5 (0.89)	33.5 (1.32)	25.0 (0.98)	165 (2400)
C-LRT-12-4T35		1/4" x 0.035"					
C-LRT-12-4-L10		1/4" x 1mm	44.8 (1.76)	10.0 (0.39)	22.4 (0.88)		
C-LRT-12-6	3/4" x 0.065"	3/8" x 1mm	67 (2.64)	22.5 (0.89)	33.5 (1.32)	25.0 (0.98)	165 (2400)
C-LRT-12-6T35		3/8" x 0.035"					
C-LRT-12-6-L10		3/8" x 1mm	44.8 (1.76)	10.0 (0.39)	22.4 (0.88)		
C-LRT-12-8	3/4" x 0.065"	1/2" x 0.049"	67 (2.64)	22.5 (0.89)	33.5 (1.32)	25.0 (0.98)	165 (2400)
C-LRT-12-8-L10		1/2" x 0.049"	44.8 (1.76)	10.0 (0.39)	22.4 (0.88)		
C-LRT-16-4	1" x 0.065"	1/4" x 1mm	76.6 (3.02)	23.3 (0.92)	38.3 (1.51)	30.0 (1.18)	165 (2400)
C-LRT-16-4T35		1/4" x 0.035"					
C-LRT-16-8		1/2" x 0.049"					

Long Cross

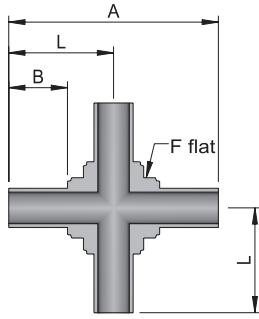

Basic Ordering Number	Tube O.D	Wall THK.	Dimensions, mm (inch)				Pressure Rating bar (psig)
			A	B	L	F	
C-LX-4	1/4"	1mm	50.0 (1.97)	19.1 (0.75)	25.0 (0.98)	11.1 (0.44)	351 (5100)
C-LX-4T35		0.035"					
C-LX-4-L10		1mm	31.8 (1.25)	10.0 (0.39)	15.9 (0.63)		
C-LX-6	3/8"	1mm	50.0 (1.97)	19.1 (0.75)	25.0 (0.98)	11.1 (0.44)	227 (3300)
C-LX-6T35		0.035"					
C-LX-6-L10		1mm	31.8 (1.25)	10.0 (0.39)	15.9 (0.63)		
C-LX-8	1/2"	0.049"	58.0 (2.28)	19.1 (0.75)	29.0 (1.14)	17.0 (0.67)	254 (3700)
C-LX-8-L10			39.8 (1.57)		10.0 (0.39)		
C-LX-12	3/4"	0.065"	67.0 (2.64)	22.5 (0.89)	33.5 (1.32)	25.0 (0.98)	165 (2400)
C-LX-12T49		0.049"					
C-LX-12-L10		0.065"	44.8 (1.76)	10.0 (0.39)	22.4 (0.88)		

Long Reducing Union

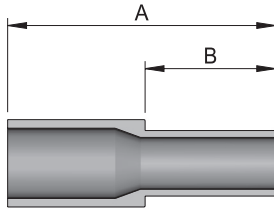

Basic Ordering Number	Tube O.D 1 x Wall THK.	Tube O.D 2 x Wall THK.	Dimensions, mm (inch)		Pressure Rating bar (psig)
			A	B	
C-LRU-6-4	3/8" x 1mm	1/4" x 1mm	38.1 (1.5)	19.1 (0.75)	227 (3300)
C-LRU-6-4-035	3/8" x 0.035"	1/4" x 0.035"			
C-LRU-6-4-L10	3/8" x 1mm	1/4" x 1mm	20.0 (0.79)	10.0 (0.39)	
C-LRU-8-4	1/2" x 0.049"	1/4" x 1mm	38.1 (1.5)	19.1 (0.75)	254 (3700)
C-LRU-8-4T35		1/4" x 0.035"			
C-LRU-8-4-L10		1/4" x 1mm	20.0 (0.79)	10.0 (0.39)	
C-LRU-8-6	1/2" x 0.049"	3/8" x 1mm	38.1 (1.5)	19.1 (0.75)	227 (3300)
C-LRU-8-6T35		3/8" x 0.035"			
C-LRU-8-6-L10		3/8" x 1mm	20.0 (0.79)	10.0 (0.39)	
C-LRU-12-4	3/4" x 0.065"	1/4" x 1mm	42.9 (1.69)	19.1 (0.75)	165 (2400)
C-LRU-12-4T35		1/4" x 0.035"			
C-LRU-12-4-L10		1/4" x 1mm	20.0 (0.79)	10.0 (0.39)	
C-LRU-12-6	3/4" x 0.065"	3/8" x 1mm	42.9 (1.69)	19.1 (0.75)	165 (2400)
C-LRU-12-6T35		3/8" x 0.035"			
C-LRU-12-6-L10		3/8" x 1mm	20.0 (0.79)	10.0 (0.39)	
C-LRU-12-8	3/4" x 0.065"	1/2" x 0.049"	42.9 (1.69)	19.1 (0.75)	165 (2400)
C-LRU-12-8-L10		1/2" x 0.049"	20.0 (0.79)	10.0 (0.39)	
C-LRU-16-4	1" x 0.065"	1/4" x 1mm	44.5 (1.75)	19.1 (0.75)	165 (2400)
C-LRU-16-4T35		1/4" x 0.035"			
C-LRU-16-6		3/8" x 1mm			
C-LRU-16-6T35		3/8" x 0.035"			
C-LRU-16-8		1/2" x 0.049"			
C-LRU-16-12		3/4" x 0.065"			

Metal Face Seal Fittings

Features

- High purity metal-to-metal seal
- Leak-tight from vacuum to positive pressure
- Minimization of clearance needed for removal and installation
- Two test ports are provided for easy leak test

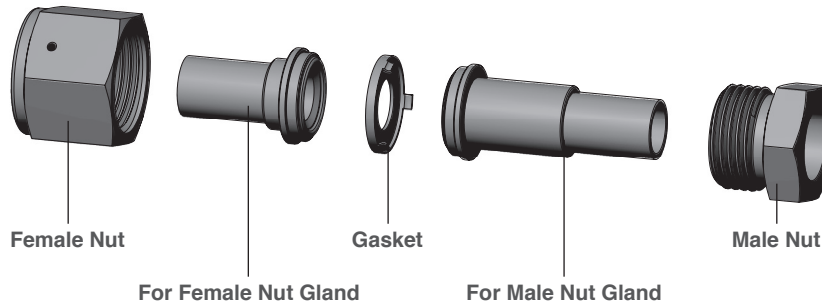

Testing

- Products are rated to a helium leak rate of 1×10^{-9} atm cc/sec.
- Tested in accordance with SEMI F1-96.

Plating

- Female nut threads are silver plated to prevent galling, ensure convenient assembly and consistent make-up.
- Chemical processes for cleaning, electro-polishing and passivation may remove plating.
- Damaged or removed plating may cause thread galling, damage of fitting components and preventing a proper seal.

Ordering Information



Clean Fitting	Product Type	Connection Size	Product Grade	Body Material
- C : S-LOK UHP Product	Refer to the basic ordering number in the dimension table.	- 4 : 1/4" - 6 : 3/8" - 8 : 1/2" - 12 : 3/4" - 16 : 1"	- BA : BA - EP : EP	- S6LS : SS316L Single Melt - S6LV : SS316L Double Melt

Micro Gland for Female Nut

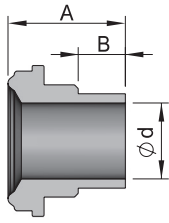

Basic Ordering Number	Head Size	Tube O.D x Wall THK.	Dimensions, mm (inch)			Pressure Rating bar (psig)	
			d	A	B	NI	SS316L
C-MGF-2	1/8"	1/8" x 0.028"	1.8 (0.07)	14.7 (0.58)	6.4 (0.25)	585 (8500)	585 (8500)
C-MGF-4	1/4"	1/4" x 1mm	4.35 (0.17)	15.2 (0.60)	6.4 (0.25)	351 (5100)	351 (5100)
C-MGF-4T35		1/4" x 0.035"	4.57 (0.18)				
C-MGF-6	1/2"	3/8" x 1mm	7.53 (0.30)	15.8 (0.62)	6.4 (0.25)	227 (3300)	227 (3300)
C-MGF-6T35		3/8" x 0.035"	7.75 (0.31)				
C-MGF-8	1/2"	1/2" x 0.049"	10.22 (0.40)	15.8 (0.62)	6.4 (0.25)	241 (3500)	241 (3500)
C-MGF-8-4		1/4" x 1mm	4.35 (0.17)				296 (4300)
C-MGF-8-4T35		1/4" x 0.035"	4.57 (0.18)				

Micro Gland for Male Nut

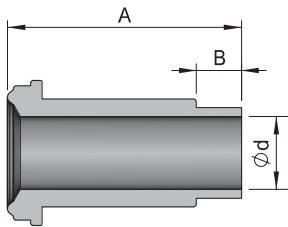

Basic Ordering Number	Head Size	Tube O.D x Wall THK.	Dimensions, mm (inch)			Pressure Rating bar (psig)	
			d	A	B	NI	SS316L
C-MGM-2	1/8"	1/8" x 0.028"	1.8 (0.07)	23.3 (0.92)	6.4 (0.25)	585 (8500)	585 (8500)
C-MGM-4	1/4"	1/4" x 1mm	4.35 (0.17)	30.5 (1.20)	6.4 (0.25)	351 (5100)	351 (5100)
C-MGM-4T35		1/4" x 0.035"	4.57 (0.18)				
C-MGM-6	1/2"	3/8" x 1mm	7.53 (0.30)	32.8 (1.29)	6.4 (0.25)	227 (3300)	227 (3300)
C-MGM-6T35		3/8" x 0.035"	7.75 (0.31)				
C-MGM-8	1/2"	1/2" x 0.049"	10.22 (0.40)	32.8 (1.29)	6.4 (0.25)	241 (3500)	241 (3500)
C-MGM-8-4		1/4" x 1mm	4.35 (0.17)				296 (4300)
C-MGM-8-4T35		1/4" x 0.035"	4.57 (0.18)				

Long Gland for Female Nut

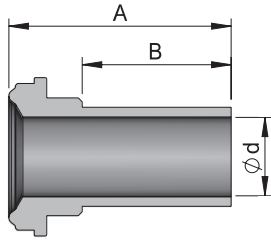

Basic Ordering Number	Head Size	Tube O.D x Wall THK.	Dimensions, mm (inch)			Pressure Rating bar (psig)	
			d	A	B	NI	SS316L
C-LGF-2	1/8"	1/8" x 0.028"	1.8 (0.07)	27.4 (1.08)	19.1 (0.75)	585 (8500)	585 (8500)
C-LGF-4	1/4"	1/4" x 1mm	4.35 (0.17)	28.0 (1.10)	19.1 (0.75)	351 (5100)	351 (5100)
C-LGF-4T35		1/4" x 0.035"	4.57 (0.18)				
C-LGF-4L10		1/4" x 1mm	4.35 (0.17)				
C-LGF-6	1/2"	3/8" x 1mm	7.53 (0.30)	28.5 (1.12)	19.1 (0.75)	227 (3300)	227 (3300)
C-LGF-6T35		3/8" x 0.035"	7.75 (0.31)				
C-LGF-6L10		3/8" x 1mm	7.53 (0.30)				
C-LGF-8	1/2"	1/2" x 0.049"	10.22 (0.40)	28.5 (1.12)	19.1 (0.75)	241 (3500)	241 (3500)
C-LGF-8L10			19.4 (0.76)	10.0 (0.39)			
C-LGF-8-4		1/4" x 1mm	4.35 (0.17)	28.5 (1.12)	19.1 (0.75)	241 (3500)	296 (4300)
C-LGF-12	3/4"	3/4" x 0.065"	15.75 (0.62)	34.5 (1.36)	19.1 (0.75)	165 (2400)	165 (2400)
C-LGF-16	1"	1" x 0.065"	22.10 (0.87)	38.6 (1.52)	19.1 (0.75)	165 (2400)	165 (2400)

Long Gland for Male Nut

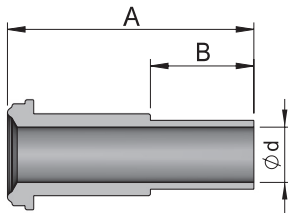

Basic Ordering Number	Head Size	Tube O.D x Wall THK.	Dimensions, mm (inch)			Pressure Rating bar (psig)	
			d	A	B	NI	SS316L
C-LGM-2	1/8"	1/8" x 0.028"	1.8 (0.07)	36 (1.42)	19.1 (0.75)	585 (8500)	585 (8500)
C-LGM-4	1/4"	1/4" x 1mm	4.35 (0.17)	43.2 (1.70)	19.1 (0.75)	351 (5100)	351 (5100)
C-LGM-4T35		1/4" x 0.035"	4.57 (0.18)				
C-LGM-4L10		1/4" x 1mm	4.35 (0.17)				
C-LGM-6	1/2"	3/8" x 1mm	7.53 (0.30)	45.5 (1.79)	19.1 (0.75)	227 (3300)	227 (3300)
C-LGM-6T35		3/8" x 0.035"	7.75 (0.31)				
C-LGM-6L10		3/8" x 1mm	7.53 (0.30)				
C-LGM-8	1/2"	1/2" x 0.049"	10.22 (0.40)	45.5 (1.79)	19.1 (0.75)	241 (3500)	241 (3500)
C-LGM-8L10			36.4 (1.43)	10.0 (0.39)			
C-LGM-8-4		1/4" x 1mm	4.35 (0.17)	45.5 (1.79)	19.1 (0.75)	241 (3500)	296 (4300)
C-LGM-12	3/4"	3/4" x 0.065"	15.75 (0.62)	51.6 (1.36)	19.1 (0.75)	165 (2400)	165 (2400)
C-LGM-16	1"	1" x 0.065"	22.10 (0.87)	58.9 (1.52)	19.1 (0.75)	165 (2400)	165 (2400)

ATW Long Gland for Female Nut

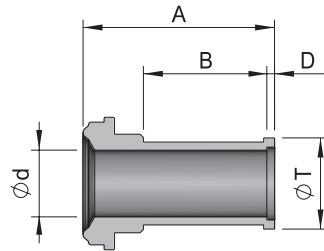

Basic Ordering Number	Head Size	Tube O.D	Dimensions, mm (inch)					Pressure Rating bar (psig)	
			d	T	A	B	D	NI	SS316L
C-ALGF-4	1/4"	1/4"	4.57 (0.18)	7.4 (0.29)	28.5 (1.12)	19.1 (0.75)	0.5 (0.02)	351 (5100)	351 (5100)
C-ALGF-6	1/2"	3/8"	7.75 (0.31)	10.4 (0.41)	29.2 (1.15)	19.1 (0.75)	0.8 (0.03)	227 (3300)	227 (3300)
C-ALGF-8	1/2"	1/2"	10.22 (0.40)	14.0 (0.55)	29.5 (1.16)	19.1 (0.75)	1.0 (0.04)	241 (3500)	241 (3500)

ATW Long Gland for Male Nut

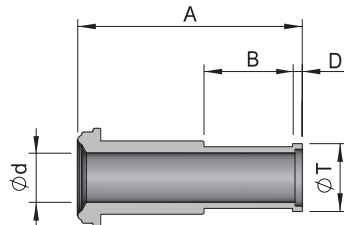

Basic Ordering Number	Head Size	Tube O.D	Dimensions, mm (inch)					Pressure Rating bar (psig)	
			d	T	A	B	D	NI	SS316L
C-ALGM-4	1/4"	1/4"	4.57 (0.18)	7.4 (0.29)	43.7 (1.72)	19.1 (0.75)	0.5 (0.02)	351 (5100)	351 (5100)
C-ALGM-6	1/2"	3/8"	7.75 (0.31)	10.4 (0.41)	46.2 (1.82)	19.1 (0.75)	0.8 (0.03)	227 (3300)	227 (3300)
C-ALGM-8	1/2"	1/2"	10.22 (0.40)	14.0 (0.55)	46.5 (1.83)	19.1 (0.75)	1.0 (0.04)	241 (3500)	241 (3500)
C-ALGM-8-4		1/4"	4.57 (0.18)	7.4 (0.29)	46.2 (1.82)	19.1 (0.75)	0.5 (0.02)		
C-ALGM-12	3/4"	3/4"	16.50 (0.65)	20.3 (0.80)	52.6 (2.07)	19.1 (0.75)	1.0 (0.04)	165 (2400)	165 (2400)
C-ALGM-16	1"	1"	22.10 (0.87)	26.9 (1.06)	65.3 (2.57)	24.4 (0.96)	1.0 (0.04)	165 (2400)	165 (2400)

Socket Weld Gland

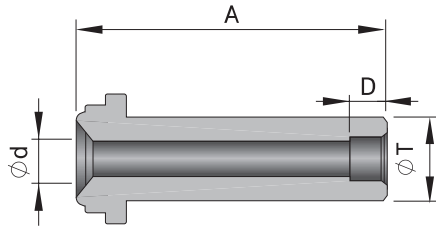

Basic Ordering Number	Head Size	Tube O.D	Dimensions, mm (inch)				Pressure Rating bar (psig)	
			d	T	A	D	NI	SS316L
C-GSW-4	1/4"	1/4"	4.57 (0.18)	8.9 (0.35)	33.3 (1.31)	7.1 (0.28)	378 (5500)	378 (5500)
C-GSW-4-12.7L					12.7 (0.50)			
C-GSW-4-19.1L					19.1 (0.75)			
C-GSW-6	1/2"	3/8"	7.11 (0.28)	15.2 (0.60)	38.1 (1.50)	7.9 (0.31)	241 (3500)	296 (4300)
C-GSW-8	1/2"	1/2"	10.22 (0.40)	15.2 (0.60)	38.1 (1.50)	9.6 (0.38)	206 (3000)	206 (3000)
C-GSW-8-4	1/2"	1/4"	4.57 (0.18)	15.2 (0.60)	38.1 (1.50)	7.1 (0.28)	241 (3500)	241 (3500)
C-GSW-12	3/4"	3/4"	15.74 (0.62)	22.4 (0.88)	50.8 (2.00)	11.2 (0.44)	192 (2800)	192 (2800)
C-GSW-16	1"	1"	22.10 (0.87)	30.2 (1.19)	56.4 (2.22)	15.7 (0.62)	165 (2400)	206 (3000)

Male Weld Gland

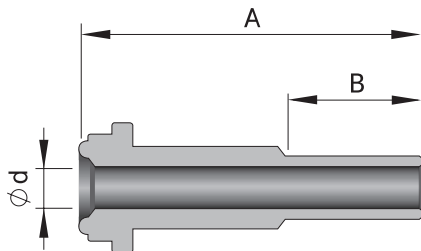

Basic Ordering Number	Head Size	Tube O.D	Dimensions, mm (inch)			Pressure Rating bar (psig)	
			d	A	B	NI	SS316L
C-GMW-4	1/4"	1/4"	3.00 (0.12)	33.3 (1.31)	10.4 (0.41)	551 (8000)	689 (10000)
C-GMW-6	1/2"	3/8"	7.11 (0.28)	38.1 (1.50)	10.4 (0.41)	241 (3500)	296 (4300)
C-GMW-8	1/2"	1/2"	10.22 (0.40)	38.1 (1.50)	12.7 (0.50)	241 (3500)	241 (3500)
C-GMW-8-4	1/2"	1/4"	3.00 (0.12)	38.1 (1.50)	10.4 (0.41)	241 (3500)	296 (4300)
C-GMW-12	3/4"	3/4"	13.50 (0.53)	50.8 (2.00)	15.7 (0.62)	206 (3000)	254 (3700)
C-GMW-16	1"	1"	19.1 (0.75)	56.4 (2.22)	20.6 (0.81)	165 (2400)	206 (3000)

Tube Adapter Gland

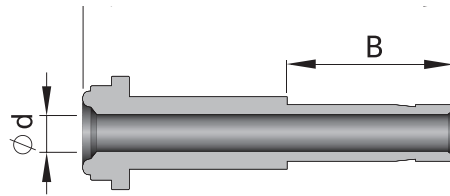

Basic Ordering Number	Head Size	Tube O.D.	Dimensions, mm (inch)			Pressure Rating bar (psig)	
			d	A	B	NI	SS316L
C-GA-4	1/4"	1/4"	4.3 (0.17)	41.0 (1.62)	16.2 (0.64)	551 (8000)	689 (10000)
C-GA-6	1/2"	3/8"	6.8 (0.27)	46.0 (1.81)	17.8 (0.70)	241 (3500)	296 (4300)
C-GA-8	1/2"	1/2"	9.4 (0.37)	49.3 (1.94)	24.4 (0.96)	241 (3500)	296 (4300)

Blind Gland

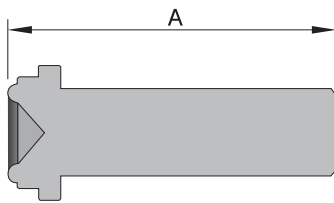

Basic Ordering Number	Head Size	Dimensions, mm (inch)
		A
C-GBL-4	1/4"	33.3 (1.31)
C-GBL-8	1/2"	38.1 (1.50)
C-GBL-12	3/4"	50.8 (2.00)
C-GBL-16	1"	56.4 (2.22)

Union

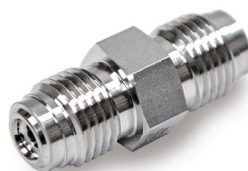
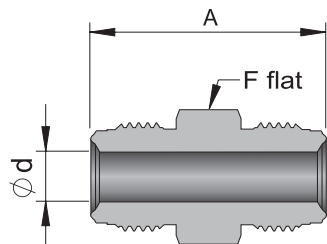

Basic Ordering Number	Head Size	Dimensions, mm (inch)			Pressure Rating bar (psig)	
		d	A	F	NI	SS316L
C-U-4	1/4"	4.3 (0.17)	39.4 (1.55)	15.88 (5/8)	551 (8000)	689 (10000)
C-U-8	1/2"	10.2 (0.40)	46.7 (1.84)	23.81 (15/16)	241 (3500)	296 (4300)
C-U-8-4	1/2" x 1/4"	10.2 x 4.3 (0.40 x 0.17)	43.4 (1.71)	23.81 (15/16)	241 (3500)	296 (4300)
C-U-12	3/4"	15.7 (0.62)	62.0 (2.44)	33.33 (1-5/16)	206 (3000)	254 (3700)
C-U-16	1"	22.1 (0.87)	65.8 (2.59)	41.28 (1-5/8)	165 (2400)	206 (3000)

Bulkhead Union

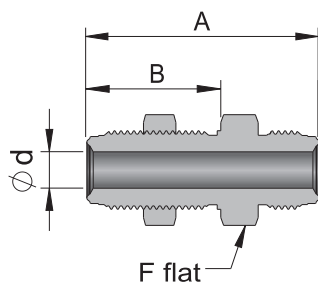

Basic Ordering Number	Head Size	Dimensions, mm (inch)				Pressure Rating bar (psig)	
		d	A	B	F	NI	SS316L
C-BU-4	1/4"	4.3 (0.17)	56.6 (2.23)	33.0 (1.30)	19.05 (3/4)	551 (8000)	689 (10000)
C-BU-8	1/2"	10.2 (0.40)	65.3 (2.57)	37.6 (1.48)	26.98 (1-1/16)	241 (3500)	296 (4300)
C-BU-12	3/4"	15.7 (0.62)	79.0 (3.11)	43.0 (1.69)	38.10 (1-1/2)	206 (3000)	254 (3700)
C-BU-16	1"	22.1 (0.87)	86.0 (3.39)	47.0 (1.85)	44.45 (1-3/4)	165 (2400)	206 (3000)

Male Connector

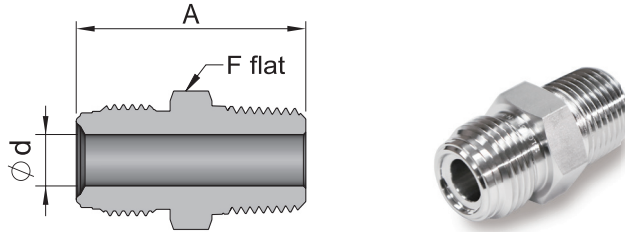

Basic Ordering Number	Head Size	NPT Size	Dimensions, mm (inch)			Pressure Rating bar (psig)	
			d	A	F	NI	SS316L
C-MC-4-2N	1/4"	1/8"	4.3 (0.17)	33.3 (1.31)	15.88 (5/8)	551 (8000)	689 (10000)
C-MC-4-4N		1/4"		37.8 (1.49)			
C-MC-8-4N	1/2"	1/4"	7.1 (0.28)	41.9 (1.65)	23.81 (15/16)	241 (3500)	296 (4300)
C-MC-8-6N		3/8"	9.6 (0.38)	41.9 (1.65)			
C-MC-8-8N		1/2"	10.2 (0.40)	46.7 (1.84)			
C-MC-12-12N	3/4"	3/4"	15.7 (0.62)	55.6 (2.19)	33.33 (1-5/16)	206 (3000)	254 (3700)
C-MC-16-16N	1"	1"	22.1 (0.87)	62.7 (2.47)	41.28 (1-5/8)	165 (2400)	206 (3000)

Tube Butt Weld Connector

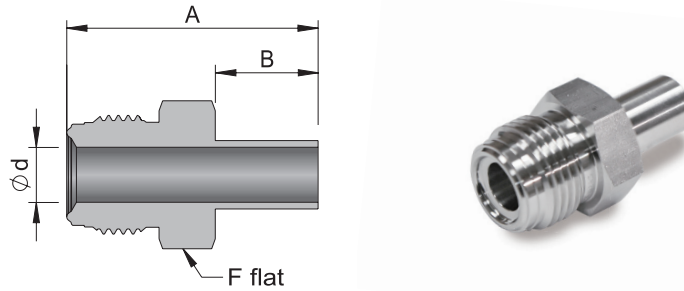

Basic Ordering Number	Head Size	Tube O.D x Wall THK.	Dimensions, mm (inch)				Pressure Rating bar (psig)	
			d	A	B	F	NI	SS316L
C-TC-4-4	1/4"	1/4" x 1mm	4.35 (0.17)	42.7 (1.68)	19.1 (0.75)	15.88 (5/8)	351 (5100)	351 (5100)
C-TC-4-4T35		1/4" x 0.035"	4.57 (0.18)					
C-TC-8-6	1/2"	3/8" x 1mm	7.53 (0.30)	46.7 (1.84)	19.1 (0.75)	23.81 (15/16)	227 (3300)	227 (3300)
C-TC-8-6T35		3/8" x 0.035"	7.75 (0.31)					
C-TC-8-8	1/2"	1/2" x 0.049"	10.22 (0.40)	46.7 (1.84)	19.1 (0.75)	23.81 (15/16)	241 (3500)	241 (3500)
C-TC-12-12	3/4"	3/4" x 0.065"	15.75 (0.62)	55.6 (2.19)	19.1 (0.75)	33.33 (1-5/16)	165 (2400)	165 (2400)

Tube Butt Weld Bulkhead Connector

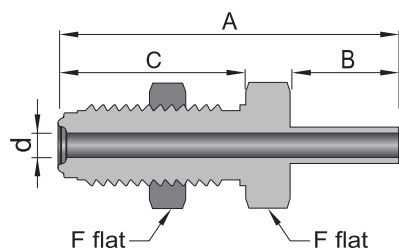

Basic Ordering Number	Head Size	Dimensions, mm (inch)					Pressure Rating bar (psig)	
		d	A	B	C	F	NI	SS316L
C-TCB-4-4	1/4"	4.35 (0.17)	59.9 (2.36)	19.1 (0.75)	33.0 (1.30)	19.05 (3/4)	351 (5100)	351 (5100)
C-TCB-4-4T35		4.57 (0.18)						
C-TCB-8-8	1/2"	10.22 (0.40)	65.3 (2.57)	19.1 (0.75)	37.6 (1.48)	26.99 (1-1/16)	241 (3500)	241 (3500)
C-TCB-12-12	3/4"	15.75 (0.62)	71.3 (2.81)	19.1 (0.75)	43.0 (1.69)	38.1 (1-1/2)	165 (2400)	165 (2400)

Coupling

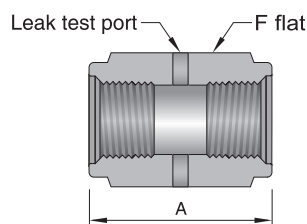

Basic Ordering Number	Head Size	Dimensions, mm (inch)	
		A	F
C-CG-2	1/8"	16.8 (0.66)	11.11 (7/16)
C-CG-4	1/4"	30.2 (1.19)	19.05 (3/4)
C-CG-8	1/2"	33.3 (1.31)	26.98 (1-1/16)
C-CG-12	3/4"	42.7 (1.68)	38.1 (1-1/2)
C-CG-16	1"	51.8 (2.04)	44.45 (1-3/4)

Union Elbow

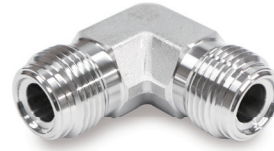
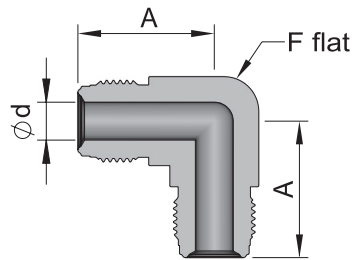

Basic Ordering Number	Head Size	Dimensions, mm (inch)			Pressure Rating bar (psig)	
		d	A	F	NI	SS316L
C-L-4	1/4"	4.3 (0.17)	27.2 (1.07)	12.7 (1/2)	551 (8000)	689 (10000)
C-L-8	1/2"	10.2 (0.40)	36.8 (1.45)	20.6 (13/16)	241 (3500)	296 (4300)
C-L-12	3/4"	15.7 (0.62)	48.8 (1.92)	31.8 (1-1/4)	206 (3000)	254 (3700)
C-L-16	1"	22.1 (0.87)	50.8 (2.00)	42.8 (1-11/16)	165 (2400)	206 (3000)

Male Elbow

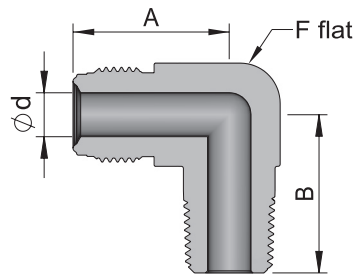

Basic Ordering Number	Head Size	NPT Size	Dimensions, mm (inch)				Pressure Rating bar (psig)	
			d	A	B	F	NI	SS316L
C-MLC-4-2N	1/4"	1/8"	4.3 (0.17)	27.2 (1.07)	22.1 (0.87)	12.7 (1/2)	551 (8000)	689 (10000)
C-MLC-4-4N		1/4"			26.7 (1.05)			
C-MLC-8-6N	1/2"	3/8"	10.2 (0.40)	36.8 (1.45)	32.0 (1.26)	20.6 (13/16)	241 (3500)	296 (4300)
C-MLC-8-8N		1/2"			36.8 (1.45)			

Union Tee

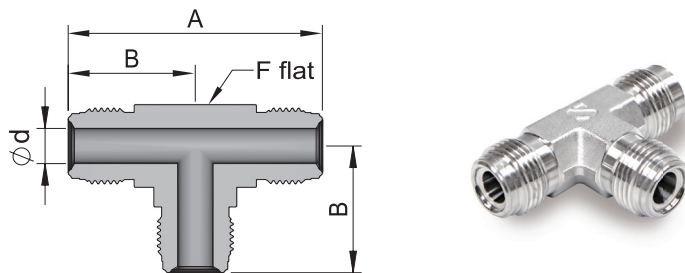

Basic Ordering Number	Head Size	Dimensions, mm (inch)				Pressure Rating bar (psig)	
		d	A	B	F	NI	SS316L
C-T-4	1/4"	4.3 (0.17)	54.4 (2.14)	27.2 (1.07)	12.7 (1/2)	551 (8000)	689 (10000)
C-T-8	1/2"	10.2 (0.40)	73.6 (2.90)	36.8 (1.45)	20.6 (13/16)	241 (3500)	296 (4300)
C-T-12	3/4"	15.7 (0.62)	97.6 (3.84)	48.8 (1.92)	31.8 (1-1/4)	206 (3000)	254 (3700)
C-T-16	1"	22.1 (0.87)	101.6 (4.00)	50.8 (2.00)	42.8 (1-11/16)	165 (2400w)	206 (3000)

Union Cross

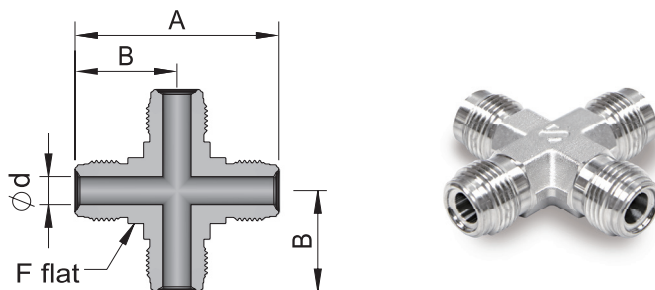

Basic Ordering Number	Head Size	Dimensions, mm (inch)				Pressure Rating bar (psig)	
		d	A	B	F	NI	SS316L
C-X-4	1/4"	4.3 (0.17)	54.4 (2.14)	27.2 (1.07)	12.7 (1/2)	551 (8000)	689 (10000)
C-X-8	1/2"	10.2 (0.40)	73.6 (2.90)	36.8 (1.45)	20.6 (13/16)	241 (3500)	296 (4300)
C-X-12	3/4"	15.7 (0.62)	97.6 (3.84)	48.8 (1.92)	31.8 (1-1/4)	206 (3000)	254 (3700)
C-X-16	1"	22.1 (0.87)	101.6 (4.00)	50.8 (2.00)	42.8 (1-11/16)	165 (2400)	206 (3000)

S-LOK Tube Fitting Connector

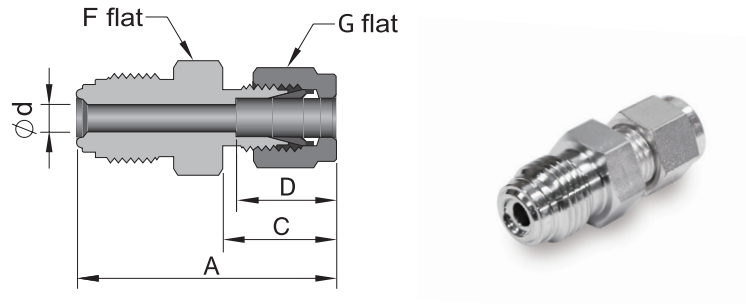

Basic Ordering Number	Head Size	Tube O.D.	Dimensions, mm (inch)						Pressure Rating bar (psig)	
			d	A	C	D	F	G	NI	SS316L
C-US-4-4T	1/4"	1/4"	4.3 (0.17)	41.1 (1.62)	17.8 (0.70)	15.2 (0.60)	15.88 (5/8)	14.28 (9/16)	551 (8000)	689 (10000)
C-US-8-6T	1/2"	3/8"	7.1 (0.28)	46.7 (1.84)	19.3 (0.76)	16.8 (0.66)	23.81 (15/16)	17.46 (11/16)	241 (3500)	296 (4300)
C-US-8-8T	1/2"	1/2"	10.2 (0.40)	49.5 (1.95)	21.8 (0.86)	22.9 (0.90)	23.81 (15/16)	22.22 (7/8)	241 (3500)	296 (4300)

S-LOK Tube Fitting Bulkhead Connector

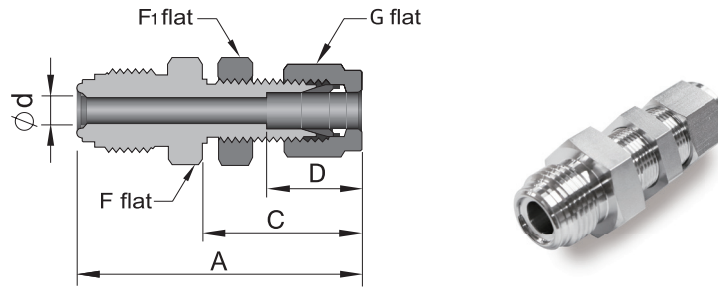

Basic Ordering Number	Head Size	Tube O.D.	Dimensions, mm (inch)									Pressure Rating bar (psig)	
			d	A	C	D	F	F1	G	Panel Drill Size	Max. Panel Thk.	NI	SS316L
C-USB-4-4T	1/4"	1/4"	4.3 (0.17)	57.2 (2.25)	33.5 (1.32)	15.2 (0.60)	15.88 (5/8)	15.88 (5/8)	14.28 (9/16)	11.9 (15/32)	10.2 (0.40)	551 (8000)	689 (10000)
C-USB-8-6T	1/2"	3/8"	7.1 (0.28)	64.5 (2.54)	36.8 (1.45)	16.8 (0.66)	23.81 (15/16)	19.05 (3/4)	17.46 (11/16)	15.0 (19/32)	11.2 (0.44)	241 (3500)	296 (4300)
C-USB-8-8T	1/2"	1/2"	10.2 (0.40)	69.6 (2.74)	41.9 (1.65)	22.9 (0.90)	23.81 (15/16)	23.81 (15/16)	22.22 (7/8)	19.8 (25/32)	12.7 (0.50)	241 (3500)	296 (4300)

Male Bulkhead Connector

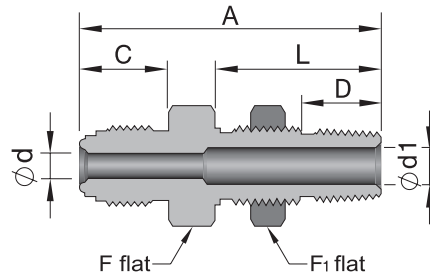

Basic Ordering Number	Head Size	NPT Size	Dimensions, mm (inch)									Pressure Rating bar (psig)			
			d	d1	A	C	D	F	F1	L	Panel Drill Size	Max. Panel Thk.	NI	SS316L	
C-MBC-4-4N	1/4"	1/4"	4.3 (0.17)	7.1 (0.28)	56.1 (2.21)	15.7 (0.62)	14.2 (0.56)	20.63 (13/16)	20.63 (13/16)	31.5 (1.24)	16.8 (21/32)	9.7 (0.38)	551 (8000)	551 (8000)	
C-MBC-8-4N	1/2"	1/4"	10.2 (0.40)	7.1 (0.28)	59.4 (2.34)	19.1 (0.75)	14.2 (0.56)	23.81 (15/16)	20.63 (13/16)	31.5 (1.24)	16.8 (21/32)	9.7 (0.38)	241 (3500)	301 (4370)	

Male Connector (Straight Thread)

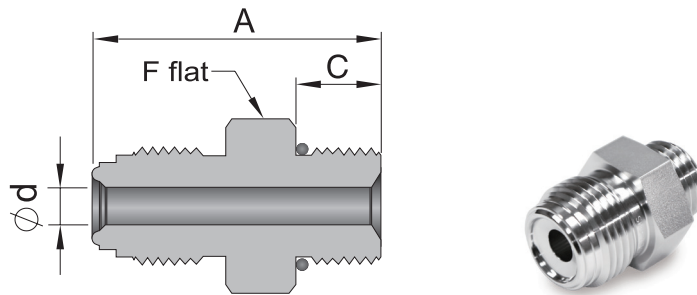

Basic Ordering Number	Head Size	Straight Thread Size	Dimensions, mm (inch)				Pressure Rating bar (psig)	
			d	A	C	F	NI	SS316L
C-MC-4-6U	1/4"	9/16-18	4.3 (0.17)	33.8 (1.33)	9.9 (0.39)	19.1 (3/4)	310 (4500)	310 (4500)
C-MC-8-6U	1/2"	9/16-18	7.1 (0.28)	37.6 (1.48)	9.9 (0.39)	23.8 (15/16)	241 (3500)	241 (3500)
C-MC-8-10U	1/2"	7/8-14	10.2 (0.40)	42.2 (1.66)	12.7 (0.50)	25.4 (1)	241 (3500)	241 (3500)

Female Connector

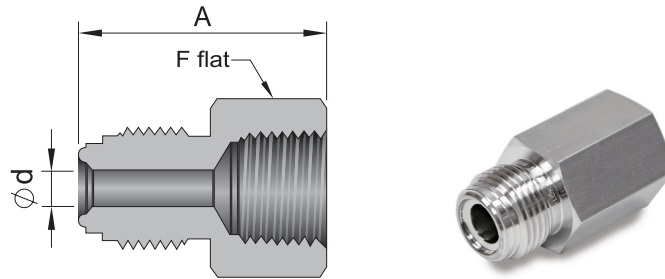

Basic Ordering Number	Head Size	NPT Size	Dimensions, mm (inch)			Pressure Rating bar (psig)	
			d	A	F	NI	SS316L
C-FC-4-2N	1/4"	1/8"	4.3 (0.17)	35.8 (1.41)	15.88 (5/8)	551 (8000)	551 (8000)
C-FC-4-4N		1/4"		39.1 (1.54)	19.05 (3/4)	454 (6600)	454 (6600)
C-FC-8-6N	1/2"	3/8"	10.2 (0.40)	44.7 (1.76)	23.81 (15/16)	241 (3500)	296 (4300)
C-FC-8-8N		1/2"		50.5 (1.99)	26.98 (1-1/16)		
C-FC-12-12N	3/4"	3/4"	15.7 (0.62)	59.9 (2.36)	33.33 (1-5/16)	206 (3000)	254 (3700)
C-FC-16-16N	1"	1"	22.1 (0.87)	63.8 (2.51)	41.28 (1-5/8)	165 (2400)	206 (3000)

Gasket Retainer Assembly

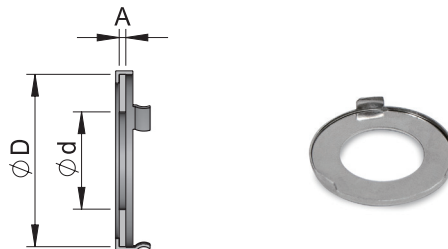

Basic Ordering Number	Head Size (ØD)	Dimensions, mm (inch)		
		d	D	A
C-GTR-4	1/4"	5.6 (0.22)	11.9 (0.47)	0.8 (0.03)
C-GTR-8	1/2"	11.2 (0.44)	19.2 (0.76)	0.8 (0.03)
C-GTR-12	3/4"	16.8 (0.66)	28.5 (1.12)	0.8 (0.03)
C-GTR-16	1"	22.6 (0.89)	35.1 (1.38)	0.8 (0.03)

• Basic ordering number of gasket retainer assembly is "C-GTR".

Gasket

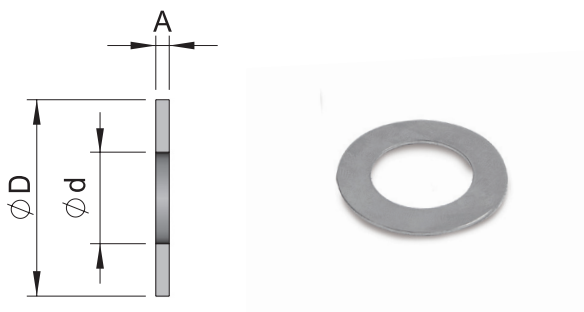

Basic Ordering Number	Head Size	Dimensions, mm (inch)		
		d	D	A
C-GT-2	1/8"	2.3 (0.09)	6.6 (0.26)	0.8 (0.03)
C-GT-4	1/4"	5.6 (0.22)	12.5 (0.49)	0.8 (0.03)
C-GT-8	1/2"	11.2 (0.44)	19.8 (0.78)	0.8 (0.03)
C-GT-12	3/4"	16.8 (0.66)	29.0 (1.14)	0.8 (0.03)
C-GT-16	1"	22.6 (0.89)	35.6 (1.40)	0.8 (0.03)

Female Nut

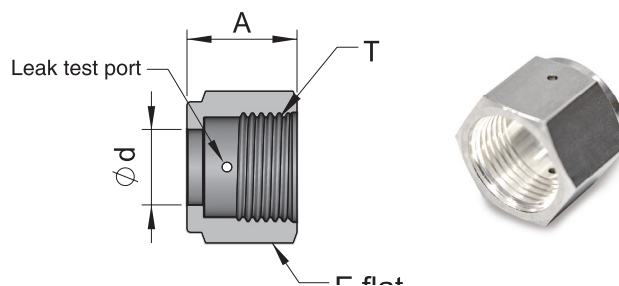

Basic Ordering Number	Head Size	Dimensions, mm (inch)			Thread T
		d	A	F	
C-NF-2	1/8"	5.3 (0.21)	13.5 (0.53)	11.11 (7/16)	5/16-24UNF
C-NF-4	1/4"	9.1 (0.36)	20.6 (0.81)	19.05 (3/4)	9/16-18UNF
C-NF-8	1/2"	15.5 (0.61)	22.4 (0.88)	26.98 (1-1/16)	7/8-14UNF
C-NF-12	3/4"	22.6 (0.89)	28.4 (1.12)	38.10 (1-1/2)	1-1/4-18UNEF
C-NF-16	1"	30.5 (1.20)	34.0 (1.34)	44.45 (1-3/4)	1-1/2-20UN

Male Nut

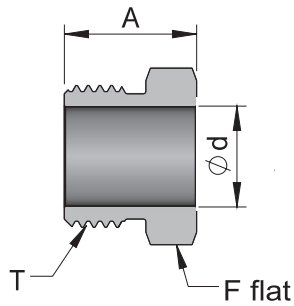

Basic Ordering Number	Head Size	Dimensions, mm (inch)			Thread T
		d	A	F	
C-NM-2	1/8"	5.3 (0.21)	12.7 (0.5)	9.52 (3/8)	5/16-24UNF
C-NM-4	1/4"	9.1 (0.36)	18.0 (0.71)	15.88 (5/8)	9/16-18UNF
C-NM-4A			13.7 (0.54)		
C-NM-4-54			16.5 (0.65)		
C-NM-4-65					
C-NM-8	1/2"	15.5 (0.61)	20.6 (0.81)	23.81 (15/16)	7/8-14UNF
C-NM-12	3/4"	22.6 (0.89)	25.4 (1.00)	33.33 (1-5/16)	1-1/4-18UNEF
C-NM-16	1"	30.5 (1.20)	30.2 (1.19)	41.28 (1-5/8)	1-1/2-20UN

• C-NM-4A has a taper at hex end, allowing the nut to move around 90° tube bends.

Cap

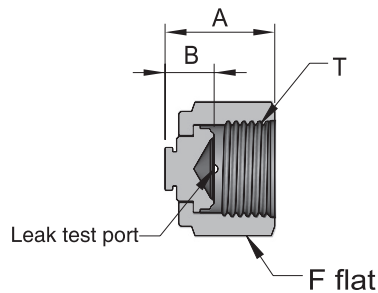

Basic Ordering Number	Head Size	Dimensions, mm (inch)			Thread T
		A	B	F	
C-CP-4	1/4"	23.9 (0.94)	11.2 (0.44)	19.05 (3/4)	9/16-18UNF
C-CP-8	1/2"	25.6 (1.01)	11.4 (0.45)	26.98 (1-1/16)	7/8-14UNF
C-CP-12	3/4"	32.8 (1.29)	13.7 (0.54)	38.10 (1-1/2)	1-1/4-18UNEF
C-CP-16	1"	39.1 (1.54)	16.0 (0.63)	44.45 (1-3/4)	1-1/2-20UN

Plug

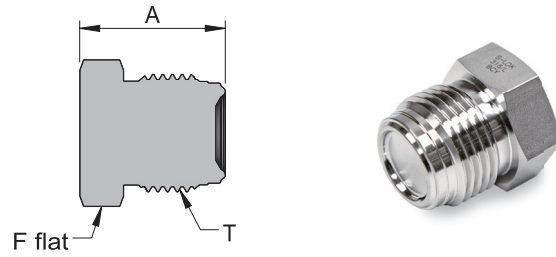

Basic Ordering Number	Head Size	Dimensions, mm (inch)		Thread T
		A	F	
C-PG-4	1/4"	23.4 (0.94)	15.88 (5/8)	9/16-18UNF
C-PG-8	1/2"	27.4 (1.01)	23.81 (15/16)	7/8-14UNF
C-PG-12	3/4"	36.3 (1.29)	33.33 (1-5/16)	1-1/4-18UNEF
C-PG-16	1"	38.6 (1.54)	41.28 (1-5/8)	1-1/2-20UN

High Flow Gland

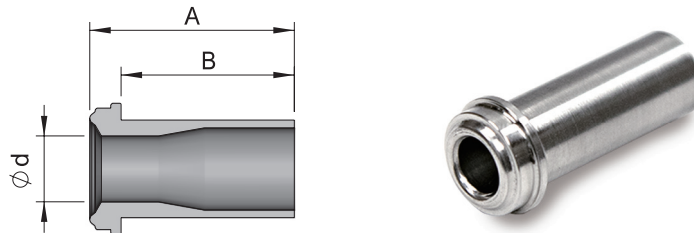

Basic Ordering Number	Head Size	Tube O.D x Wall THK.	Dimensions, mm (inch)			Pressure Rating bar (psig)	
			d	A	B	NI	SS316L
C-HG-4-6	1/4"	3/8" x 1mm	6.4 (0.25)	33.2 (1.31)	28.4 (1.12)	V227 (3300)	V227 (3300)
C-HG-4-6T35		3/8" x 0.035"					

High Flow Female Nut

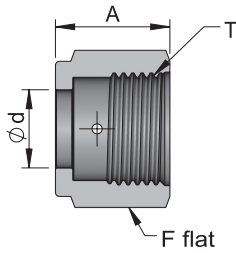

Basic Ordering Number	Head Size	Dimensions, mm (inch)			Thread T
		d	A	F	
C-HNF-4	1/4"	9.90 (0.39)	20.75 (0.82)	19.05 (3/4)	9/16-18UNF

High Flow Male Nut

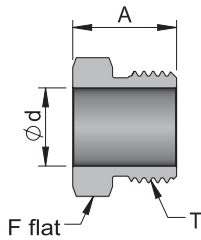

Basic Ordering Number	Head Size	Dimensions, mm (inch)			Thread T
		d	A	F	
C-HNM-4	1/4"	9.90 (0.39)	18.30 (0.72)	15.88 (5/8)	9/16-18UNF

Welded Male Connector

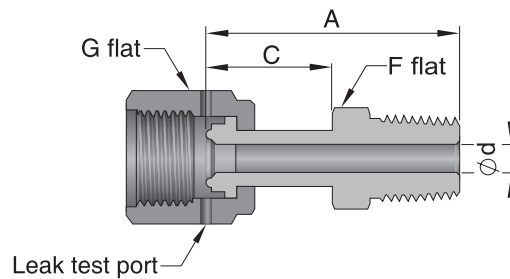

Basic Ordering Number	Head Size	NPT Size	Dimensions, mm (inch)				
			d	A	C	F	G
C-WMC-4-4N	1/4"	1/4"	4.3 (0.17)	45.5 (1.79)	23.4 (0.92)	14.28 (9/16)	19.05 (3/4)
C-WMC-8-6N	1/2"	3/8"	10.2 (0.40)	48.0 (1.89)	25.4 (1.00)	17.46 (11/16)	26.98 (1-1/16)
C-WMC-8-8N	1/2"	1/2"	10.2 (0.40)	53.1 (2.09)	25.6 (1.01)	22.22 (7/8)	26.98 (1-1/16)

Welded Female Connector

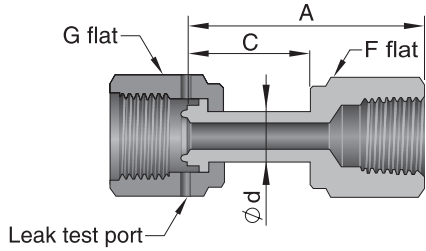

Basic Ordering Number	Head Size	NPT Size	Dimensions, mm (inch)				
			d	A	C	F	G
C-WFC-4-4N	1/4"	1/4"	4.3 (0.17)	45.0 (1.77)	23.4 (0.92)	19.05 (3/4)	19.05 (3/4)
C-WFC-8-6N	1/2"	3/8"	10.2 (0.40)	49.5 (1.95)	26.9 (1.06)	22.22 (7/8)	26.98 (1-1/16)
C-WFC-8-8N	1/2"	1/2"	10.2 (0.40)	55.4 (2.18)	26.4 (1.04)	26.98 (1-1/16)	26.98 (1-1/16)

Welded S-LOK Tube Fitting Connector

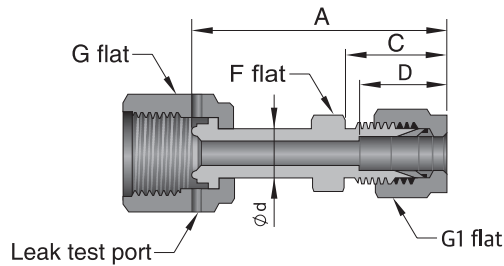

Basic Ordering Number	Head Size	Tube Size	Dimensions, mm (inch)						
			d	A	C	D	F	G	G1
C-WUS-4-4T	1/4"	1/4"	4.3 (0.17)	49.3 (1.94)	17.8 (0.70)	15.2 (0.60)	12.7 (1/2)	19.05 (3/4)	14.28 (9/16)
C-WUS-4-6T	1/4"	3/8"	4.3 (0.17)	50.0 (1.97)	19.3 (0.76)	16.8 (0.66)	15.88 (5/8)	19.05 (3/4)	17.46 (11/16)
C-WUS-8-8T	1/2"	1/2"	10.2 (0.40)	56.6 (2.23)	21.8 (0.86)	22.9 (0.90)	20.63 (13/16)	26.98 (1-1/16)	22.22 (7/8)

Close Coupling

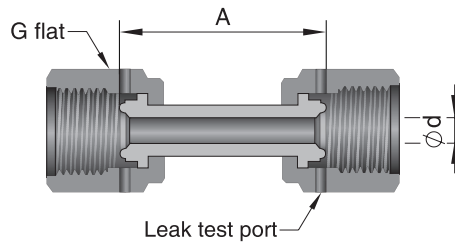

Basic Ordering Number	Head Size	Dimensions, mm (inch)		
		d	A	G
C-CC-4	1/4"	4.3 (0.17)	43.4 (1.71)	19.05 (3/4)
C-CC-8	1/2"	10.2 (0.40)	46.7 (1.84)	26.98 (1-1/16)

Welded Elbow Female Union

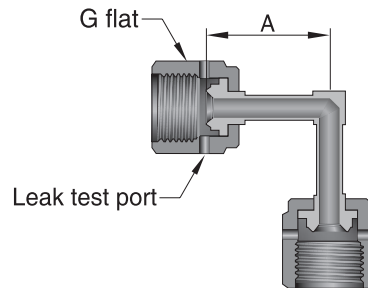

Basic Ordering Number	Head Size	Dimensions, mm (inch)	
		A	G
C-WL-FF-4	1/4"	38.3 (1.51v)	19.05 (3/4)
C-WL-FF-4L25	1/4"	25.4 (1.00)	19.05 (3/4)

Welded Tee Female Union

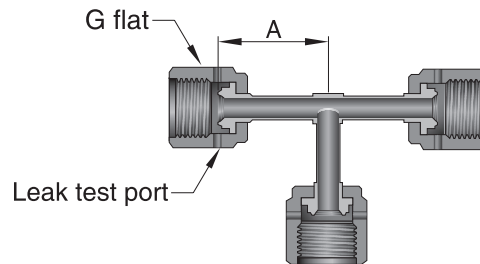

Basic Ordering Number	Head Size	Dimensions, mm (inch)	
		A	G
C-WT-FFF-4	1/4"	38.3 (1.51)	19.05 (3/4)
C-WT-FFF-4L25	1/4"	25.4 (1.00)	19.05 (3/4)

S-LOK[®]